



# Asian American and Pacific Islander Educators Network

Hybrid Meeting

Thursday, February 8, 2024

4:30 - 6:00 p.m.

<https://www.sccoe.org/sclis/aapi>



# Welcome & Introductions



**Dr. Deborah Gorgulho**

Assistant Superintendent, Educational  
Progress Division / Interim Assistant  
Superintendent Professional Learning &  
Support Division

# Emergency Preparedness



- Identify CPR/First Aid-Certified individuals in the room
- For emergencies, dial **9-1-1** from a landline



- Notify SCCOE Staff if you require assistance exiting
- A wheelchair is available (1<sup>st</sup> Floor, North Building)



- [See the complete Emergency Plan on the SCCOE Website](#)

# Emergency Evacuation Site

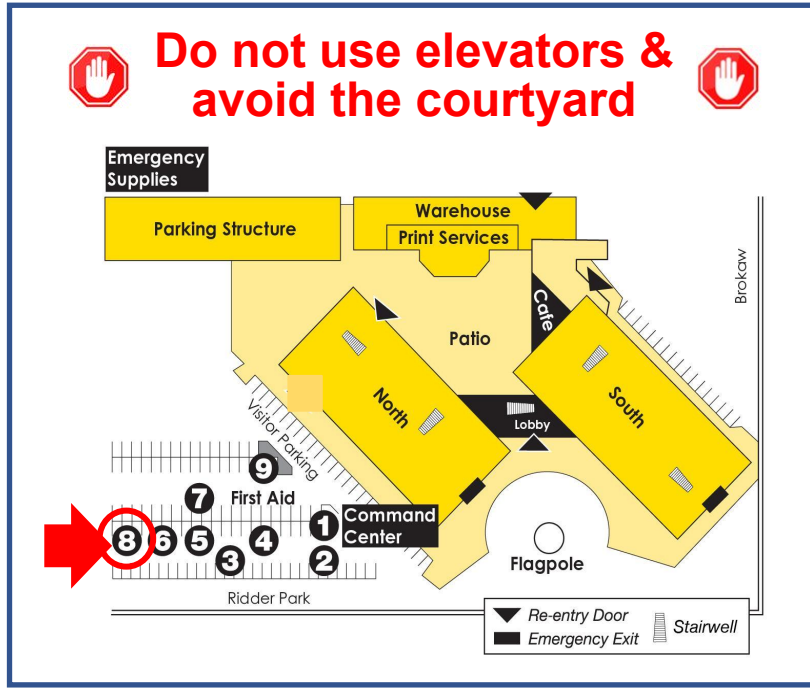

- Presenter to point out **Assembly Area 8**, 2 stairwells/exits
- Follow staff to vacate the building
- Join your group in the parking lot at Assembly Area 8
- Do not go to your car or leave the parking lot until attendance reporting is completed

# Emergency Devices

Emergency devices are located on each floor at the south end of the walkways connecting North and South buildings



Fire  
Extinguishers



Automated External  
Defibrillator (AED)



Narcan Naloxone  
Nasal Spray

# Leadership, Service, & Advocacy

## County Superintendent of Schools



Dr. Mary Ann Dewan

## County Board of Education



Maimona Afzal Berta  
Area 6



Victoria Chon  
Area 5



Joseph Di Salvo  
Area 4



Raeena Lari  
Area 7



Grace Mah  
Area 1



Don Rocha  
Area 3



Tara Sreekrishnan  
Area 2

# Agenda

## **I. Welcome & Introductions**

## **II. Facilitated Discussion: *Mental Health Support for Students and Families Through a Cultural Lens***

## **III. Discussion and Reflection**

## **IV. Networking & Dinner**



# Land Acknowledgment

The AAPI Educators' Network is committed to showing respect and honoring the Indigenous Peoples of the land.

We honor and acknowledge that we are on their traditional territories and ancestral homelands. This area was also the site of trade, hunting, gathering, and healing for many other Native Nations: The Tamien [Tae mi yen], The Muwekma [Mew-Eck-Muh], Ohlone [Oh-Lone-ee], and many others.

# Land Acknowledgment cont'd

We recognize the Indigenous peoples as the original stewards of the land, water, plants, and animals who called this place home.

As these words of acknowledgment are spoken and heard, the ties that these nations have to their traditional homelands are renewed and reaffirmed.

We respect the many diverse Indigenous peoples still connected to this land on which we gather. We pay our respect to them and give thanks to all Tribal Nations and the ancestors of this place.

# Statement of Solidarity

**The Santa Clara County Office of Education (SCCOE) in collaboration with the Asian American and Pacific Islander Educators Network affirms its commitment to...**

- creating inclusive, affirming, and equitable school environments for each and every Asian American and Pacific Islander student, family, and staff of our Santa Clara County schools. This statement thus provides rationale and a foundation for operationalizing equity and social justice at the systems level for the Asian American and Pacific Islander students, families, and staff who make up our school communities.
- recognizing that the broad categories of “Asian American” and “Pacific Islander”, [when disaggregated](#), encompass a diversity of cultures, languages, religions, histories, geographical ties, immigration status, socio-economic backgrounds, and generations among over 50 ethnic groups, comprising almost [90,000 K-12 students](#) (35.3%) across Santa Clara County.

# Introductions

**HELLO**  
my name is

- Name
- Role
- District
- One Word

**Use *one* word  
to describe  
how you feel  
right now.**



# Facilitated Discussion

Mental Health Support for Students and Families  
Through a Cultural Lens

# Discussion Moderator



**Tina Tong Choy**

Principal, Cherrywood Elementary School,  
Berryessa Union School District

# Topic Professionals



**Dr. Annya Artigas**

Director of Social Emotional Learning,  
Alum Rock Union School District



**Elaine Schultz**

Social Worker

Cherrywood Elementary School, Berryessa Union School  
District

# Additional Panelists



**Betty Chen**

Fifth Grade Teacher

Cherrywood Elementary School, BUSD



**Jeannie Young**

Parent

Cherrywood Elementary School, BUSD



**Om Swaroop**

Student

Cherrywood Elementary School, BUSD



# Discussion: *Mental Health Support for Students and Families*

- **Discussion Question 1**

- In your experience, what have you observed as the unique and evolving needs of staff, students, and parents when it comes to mental health care and well-being? How is your school site currently addressing and supporting these needs?



# Discussion: *Mental Health Support for Students and Families*

- **Discussion Question 2**

- Can you share specific examples of mindful practices that have been successfully implemented to promote mental health and social-emotional learning? What does success look like in these instances, and how have they positively impacted the community?



# Discussion: *Mental Health Support for Students and Families*

- **Discussion Question 3**

- Drawing from your expertise, what advice would you offer to educators, students, and families seeking to enhance their mental health and well-being? Are there specific strategies or resources you find particularly effective?



# Discussion: *Mental Health Support for Students and Families*

- **Discussion Question 4**

- Initiating discussions about mental health is crucial. How do you approach and begin these conversations with educators, students, and families in a way that fosters open dialogue and understanding?



# Discussion: *Mental Health Support for Students and Families*

- **Discussion Question 5**

- Considering the diverse roles within an educational setting, how do you believe your practices can be specifically beneficial to teachers, site administrators, and other staff members? In what ways do these practices contribute to a supportive and thriving school environment?





**Discussion**

**Reflection**

# Discussion and Reflection

- What are the perceptions of Asian American youth?
- Why is it important to understand the narratives of Asian American students?
- What can you do as educators to respond to the needs of Asian American youth?

# Networking and Dinner

*Enjoy!*





# Planning Committee Members

- Francesca Lomotan, Santa Clara County Office of Education
- Kasturi Basu, Alum Rock Union School District
- Keysha Doutherd, Santa Clara County Office of Education
- Dr. Hong Nguyen, San Ramon Valley Unified School District
- Joanna Shea, East Side Union High School District
- Jessica Simpson, Santa Clara County Office of Education
- Jas Sohal, Santa Clara County Office of Education
- Tina Tong Choy, Berryessa Union School District
- Dr. Yee Wan, Santa Clara County Office of Education



# *Please Provide Feedback*

<https://www.surveymonkey.com/r/aapien020824>

THANK YOU!



# 2023-24 Hybrid Network Meetings

4:30 to 6:00 p.m.

May 6, 2024



[Invite your colleagues to register!](#)



# **Jessica Simpson, Ed.S.**

Director, School Climate, Leadership  
& Instructional Services  
Professional Learning & Support Division

[jsimpson@sccoe.org](mailto:jsimpson@sccoe.org)

(408) 453-4444

# Santa Clara County Office of Education

Working collaboratively with school and community partners, the **Santa Clara County Office of Education (SCCOE)** is a regional service agency committed to serving, inspiring, and promoting student and public school success. The SCCOE is a premier service organization driven by the core principles of equity, diversity, inclusion, and partnership.

For more information about the Santa Clara County Office of Education, please visit [www.sccoe.org](http://www.sccoe.org)



@SCCOE



@santaclarasccoe



@santa-clara-county-  
office-of-education